

99284

Dimensions

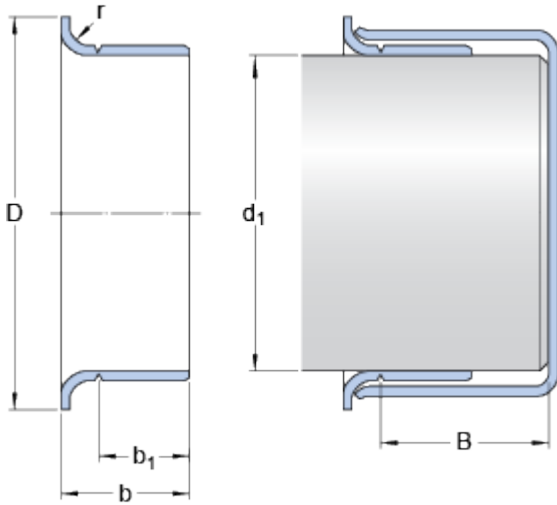

Nominal dimensions

d_1		72	mm
D		81.915	mm
Tolerance outside diameter D	\pm	1.6	mm
b		22.225	mm
Tolerance width b	\pm	0.8	mm
b_1		19.05	mm
Tolerance width b_1	\pm	0.8	mm
B	max.	34.112	mm
r	max.	3.18	mm

Shaft diameter range

d_1	min.	71.831	mm
d_1	max.	72.009	mm